



Bluffton Parking Lot & Alley Improvements

June 30, 2021



ENGINEERING
RESOURCES, INC.

4175 New Vision Drive
Fort Wayne, IN 46845

www.eri.consulting

Public Parking Lots

**NE Corner of Perry & Marion St.
&
SE Corner of Perry & Scott St.**

PUBLIC PARKING LOT EXHIBITS

- **Parking Lot Entry Points**
 - Minimize number of entry points to minimize confusion and conflicts
 - Clearly defined parking lot entry points for improved navigation
 - Allows for less pedestrian crossings of entry points
- **Remove head in parking along streets**
 - Eliminates need to back into streets when exiting parking lot
 - Provides room for safe pedestrian connections and circulation
- **Introduce softscape areas**
 - Buffers cars from pedestrian circulation
 - Can help create a more inviting and pleasant experience
 - Give the impression of intentionally provided public parking
- **Remove angled parking**
 - Simplifies vehicular circulation patterns

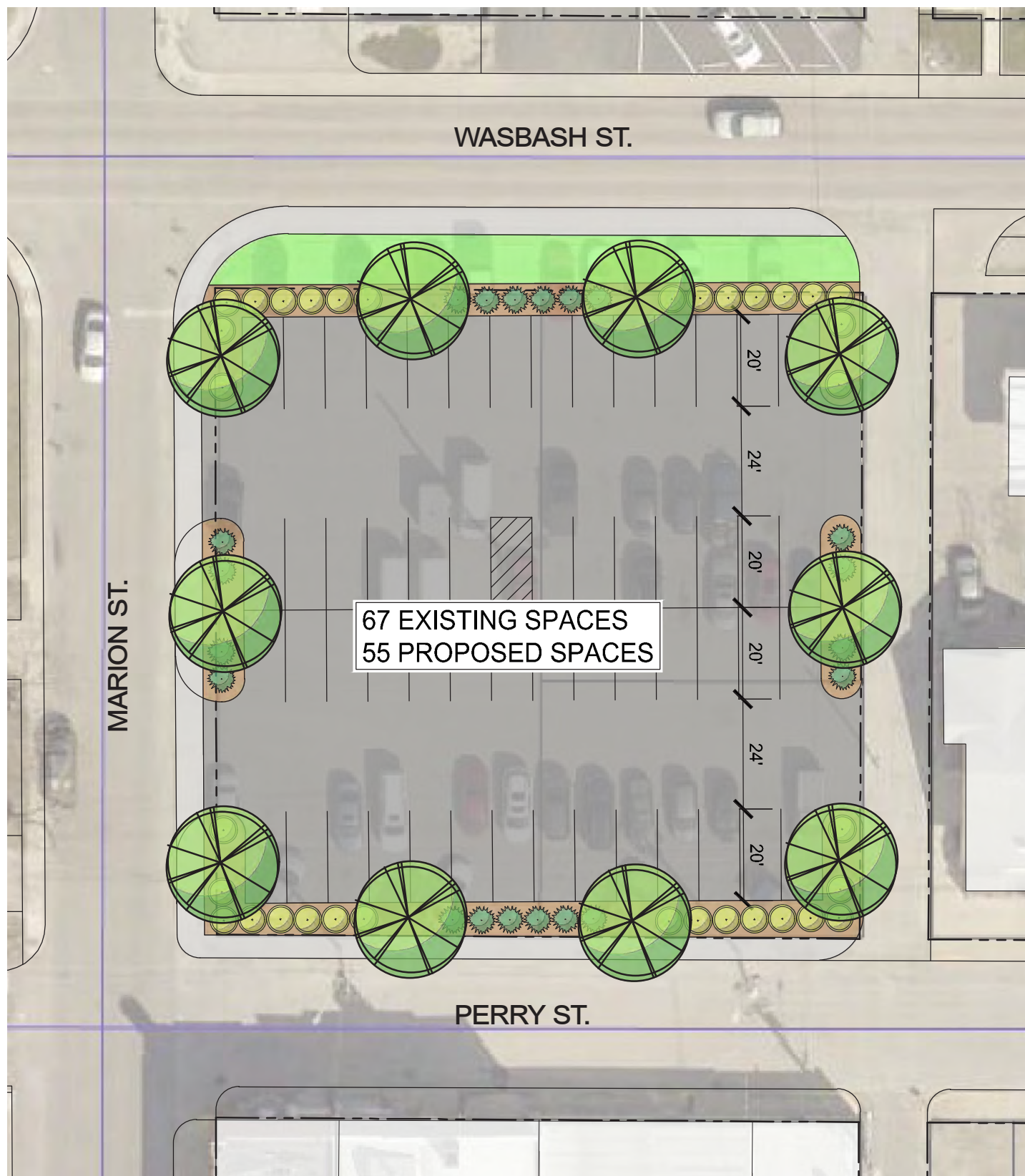

West Parking Lot Exhibit

SCALE: 1" = 30'

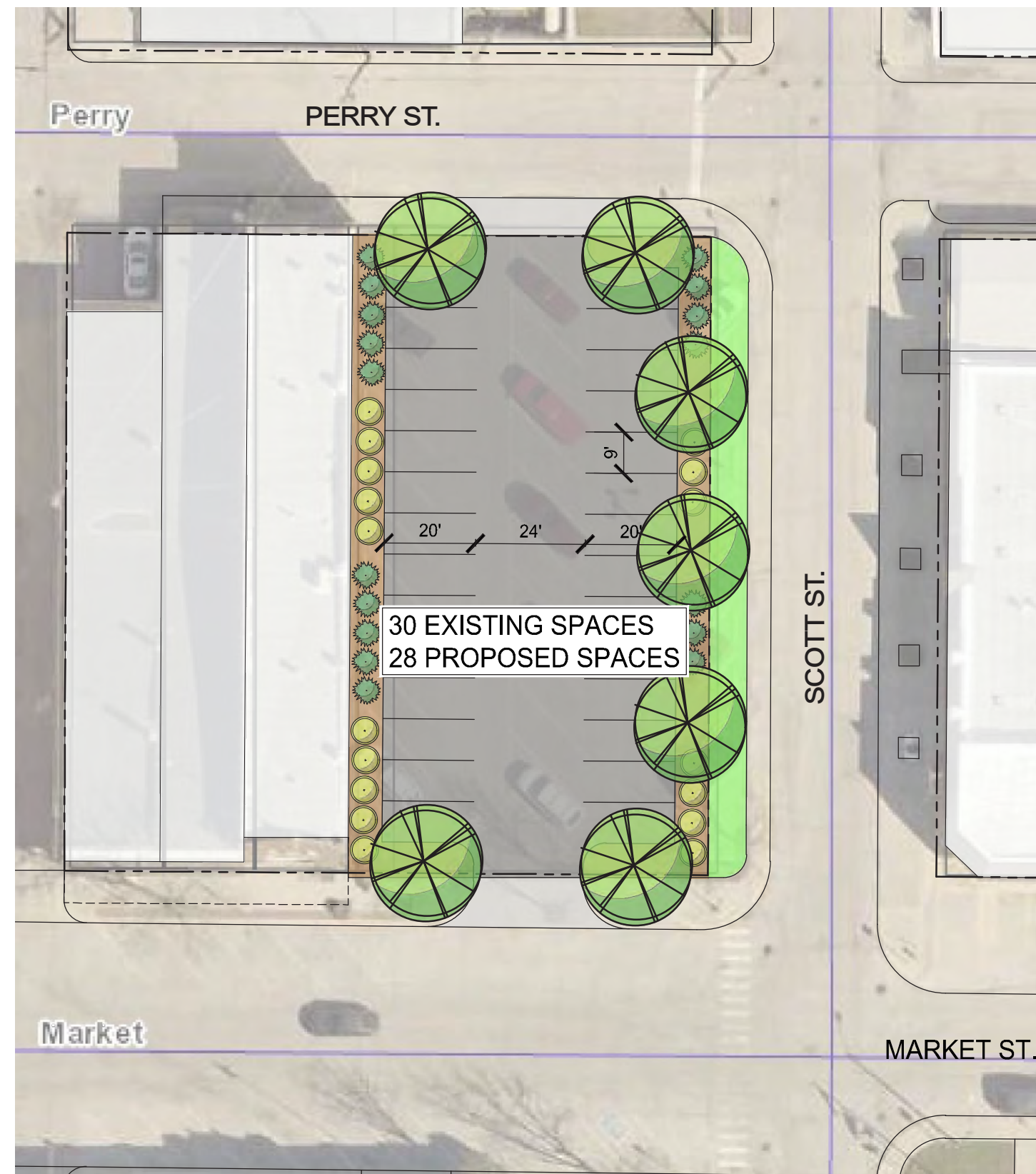

East Parking Lot Exhibit

SCALE: 1" = 30'

Allys Re-imagined

North & South of County Courthouse



ALLEYS RE-IMAGINED

- **Pedestrian connections**
 - Strategic development of alleys that can provide pedestrian connections to various downtown amenities
 - Providing safe and active pedestrian corridors
 - Generate increased pedestrian foot traffic around downtown businesses
- **City Beautification**
 - Utilizes previously underutilized and under-appreciated spaces
 - Creating interest, attention and place-making
 - Spaces to spend time downtown, increasing awareness and pride in downtown
- **Flexibility**
 - Spaces that can serve multiple purposes and function for both pedestrians and vehicles
 - Elements that can be mimicked or replicated in other areas to help create a downtown identity and unity
 - Can adapt it's uses to the surrounding businesses and amenities
- **Community Engagement**
 - Creates opportunities for community projects to be displayed or take place
 - Places for people of the community to interact and share experiences

NORTH ALLEY - PEDESTRIAN ONLY



BEFORE



AFTER

NORTH ALLEY - PEDESTRIAN ONLY



BEFORE



AFTER

NORTH ALLEY - VEHICULAR / PEDESTRIAN



BEFORE



AFTER

SOUTH ALLEY - VEHICULAR / PEDESTRIAN



BEFORE



AFTER

SOUTH ALLEY - PEDESTRIAN ONLY



BEFORE



AFTER

SOUTH ALLEY - VEHICULAR / PEDESTRIAN



BEFORE



AFTER



4175 New Vision Drive
Fort Wayne, IN 46845

www.eri.consulting

260-490-1025